



# LE1 OEM PRESSURE TRANSMITTER

## DESCRIPTION & FEATURES

- Developed for OEM applications
- Compact stainless steel construction with ceramic sensor
- Available ranges include Vac up to 8,700 psi (600 bar)
- Wide range of mechanical and electrical connections
- $\pm 0.5\%$  accuracy ( $\pm 1\%$  for pressures  $\leq 45$  psi)
- IP65 and IP67 enclosure ratings
- CE approved
- 5 year warranty

## APPLICATIONS

Suitable for all process and automation control, hydraulics and pneumatic sensing, pump and compressor monitoring, refrigeration and HVAC

## SPECIFICATION

Output Signal Standard	2-wire: 4-20 mA / $V_s = 12-30$ Vdc Optional 3-wire: 0.5-4.5 Vdc / $V_s = 10-30$ Vdc / Vac	Wetted Parts	Seals: NBR Diaphragm: Ceramic
Accuracy	$\pm 0.5\%$ FSO ( $\pm 1\%$ FSO for pressures $\leq 45$ psi (3 bar))	Current Consumption	2-wire: 25 mA max 3-wire voltage: 5 mA (short-circuit current 20 mA)
Response Time	<10 ms	EMC	EMI: EN50081-1/-2 EMS: EN50082-2
Insulation	>100 M $\Omega$ @ 50V	Stability	Vibration: 10 g / 5 Hz to 200 Hz Shock: 20 g / 11 ms
Permissible Temperatures	Operating: $-40^\circ\text{F}$ to $212^\circ\text{F}$ ( $-40^\circ\text{C}$ to $100^\circ\text{C}$ )	Operation Life	2 M cycles
Pressure Port / Housing	304 SS	Approval	CE

## ORDER CODES

Products in bold are normally stock in North America

Range	Over-pressure	Burst pressure	Code
30"/0/60 psi	75 psi	150 psi	LE10060
30"/0/100 psi	150 psi	300 psi	LE10100
30"/0/150 psi	225 psi	450 psi	LE10150
0/15 psi	23 psi	45 psi	LE115
0/25 psi	38 psi	75 psi	LE125
0/50 psi	75 psi	150 psi	LE150
0/60 psi	90 psi	180 psi	LE160

Range	Over-pressure	Burst pressure	Code
0/100 psi	150 psi	300 psi	LE1100
0/150 psi	225 psi	450 psi	LE1150
0/200 psi	300 psi	600 psi	LE1200
0/300 psi	450 psi	900 psi	LE1300
0/500 psi	750 psi	1,500 psi	LE1500
0/1,000 psi	1,500 psi	3,000 psi	LE11000
0/2,000 psi	3,000 psi	6,000 psi	LE12000

### Note:

Specifications are subject to change without prior notice.

# LE1 OEM PRESSURE TRANSMITTER



Range	Over-pressure	Burst pressure	Code
-1/4 bar	6 bar	12 bar	LE10060R11
-1/6 bar	9 bar	18 bar	LE10100R11
-1/10 bar	15 bar	30 bar	LE10150R11
0/1 bar	2 bar	3 bar	LE115R11
0/1.6 bar	2 bar	5 bar	LE125R11
0/2.5 bar	4 bar	8 bar	LE150R11
0/4 bar	6 bar	12 bar	LE160R11
0/6 bar	9 bar	18 bar	LE1100R11



Range	Over-pressure	Burst pressure	Code
0/10 bar	15 bar	30 bar	LE1150R11
0/16 bar	24 bar	48 bar	LE1200R11
0/25 bar	38 bar	75 bar	LE1300R11
0/40 bar	60 bar	120 bar	LE1500R11
0/60 bar	90 bar	180 bar	LE11000R11
0/100 bar	150 bar	300 bar	LE12000R11
0/160 bar	240 bar	480 bar	LE13000R11

## STRUCTURE

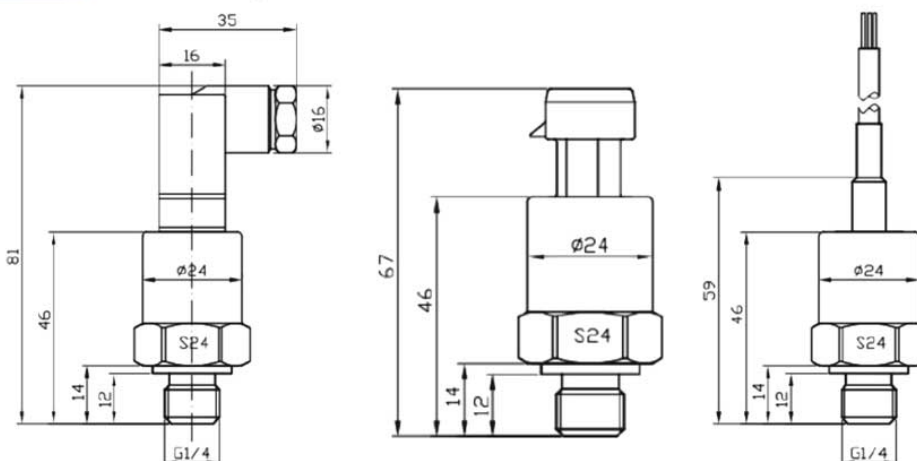
Electrical Connection

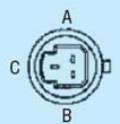

## Wiring Diagram

 <b>Micro</b>			 <b>Packard</b>			 <b>Cable Leads</b>			 <b>M12</b>	
Pin #:	2-wire (current)	3-wire (voltage)	Pin #:	2-wire (current)	3-wire (voltage)	Cable colours	2-wire (current)	3-wire (voltage)	Pin #:	Electrical Connection
1	Vcc	Vcc	A	No Connection	Ground	Red	Vcc	Vcc	1	Supply+
2	Iout	Ground	B	Vcc	Vcc	Green/Blue	Iout	Ground	2	Supply-
3	No Connection	Vout	C	Iout	Vout	Black	No Connection	Vout	3	Signal+ (for 3-wire)
4	Shield	Shield	-	-	-	Yellow	Shield	Shield	4	Shield

**Note:**  
Specifications are subject to change without prior notice.